

## QLF-1400-50

DC~1.4GHz, 50dB

**Features:**

- \* High Stopband Rejection
- \* Small Size

**Applications:**

- \* Telecom
- \* Laboratory Test
- \* Receivers
- \* Instrumentation

**Electrical**

Frequency:	DC~1.4GHz
Stop Band Attenuation:	50dB (@2GHz max.)
Insertion Loss:	2dB max.
VSWR:	1.6 max.
Input Power:	50W max.

**Mechanical**

Size*1:	35*12*8mm 1.378*0.472*0.315in
RF Connectors:	SMA female
Mounting:	4-M2, depth 5mm

[1] Exclude connectors.

**Environmental**

Operating Temperature:	-40~+70°C
Non-operating Temperature:	-55~+85°C

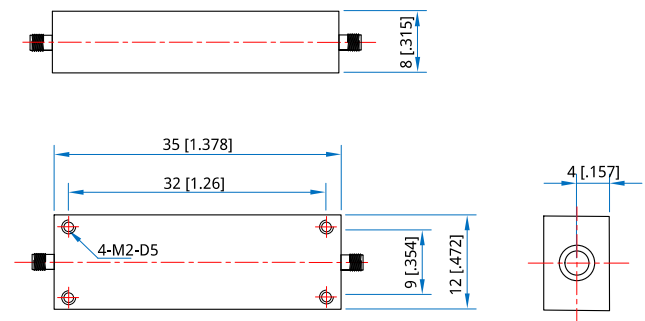
**Outline Drawings**

Unit: mm [in]

Tolerance:  $\pm 0.2$ mm [ $\pm 0.008$ in]

**How To Order**

**QLF-1400-50**

Customization is available upon request.